

PART NUMBER	DESCRIPTION	MATERIAL
FP-TPF2-5	LIFT ARM ADJUSTABLE PLATE	3/8" HRS

REVISIONS			
REV.	DESCRIPTION	DATE	APPROVED
A	UPDATED TO NEW STANDARD DWG # FROM TPF2-1	1/7/2013	

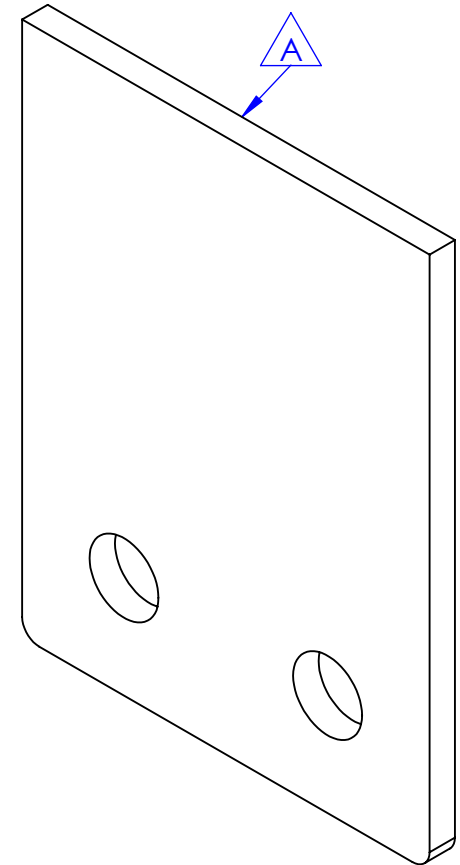
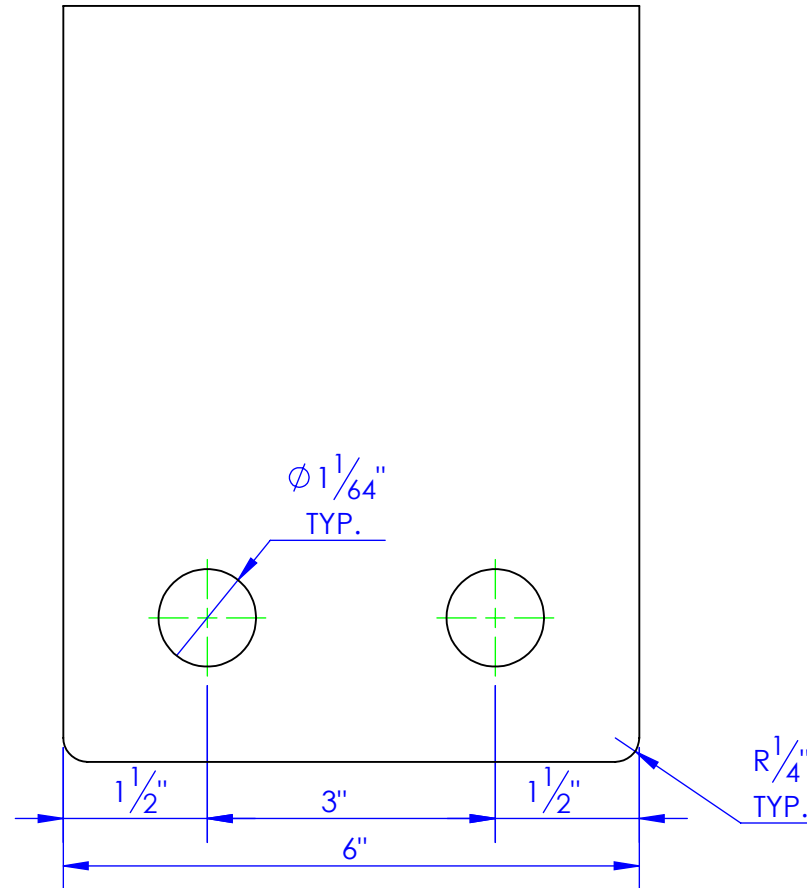
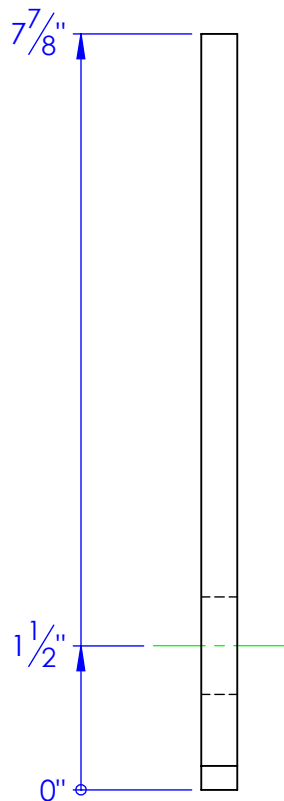

REQD QTY: 2

PROPRIETARY AND CONFIDENTIAL
THE INFORMATION CONTAINED IN THIS
DRAWING IS THE SOLE PROPERTY OF TRIPLE
C INC. ANY REPRODUCTION IN PART OR
AS A WHOLE WITHOUT THE WRITTEN
PERMISSION OF TRIPLE C INC. IS PROHIBITED.

DIMENSIONS ARE IN INCHES
TOLERANCES:
FRACTIONAL $\pm 1/16$
ANGULAR: MACH ± 1 BEND \pm
TWO PLACE DECIMAL ± 010
THREE PLACE DECIMAL ± 005

MATERIAL 3/8" HRS
DO NOT SCALE DRAWING

NAME	DATE
DRAWN HEATH	1/7/2013
PART # FP-TPF2-5	
ASM #	
COMMENTS:	
LIFT ARM ADJUSTABLE PLATE	

P.O. BOX 248,
SABETHA, KS 66534

TRIPLE C
INC.

SIZE	DWG. NO.	REV.
A	60-2108	A
SCALE: 1:2	WEIGHT: 4.85	SHEET 1 OF 1